

GENERAL NOTES

- 1. ALL GYPSUM BOARD WALLS SHALL BE PAINTED SATIN OR EGGSHELL UNLESS NOTED OTHERWISE ON PLANS.
- 2. ALL GYPSUM BOARD CEILINGS & SOFFITS SHALL BE PAINTED FLAT, UNLESS OTHERWISE NOTED ON PLANS.
- 3. FLOOR TRANSITIONS SHALL OCCUR AT THE CENTERLINE OF DOOR, UNLESS OTHERWISE NOTED.
- 4. FLOORING CONTRACTOR TO PROVIDE AND CONTINUE SCHEDULED FLOORING FROM PARTITION TO PARTITION AND UNDER MILLWORK UNLESS OTHERWISE NOTED.
- 5. PROVIDE SCHEDULED RUBBER BASE ON CASEWORK TOE-KICK TYPICAL. REFER TO CASEWORK SECTIONS/DETAILS.
- 6. PROVIDE 4" HIGH COVE BASE AT ALL CARPETED AREAS AND ALL HARD SURFACE FLOORING AREAS UNLESS OTHERWISE NOTED ON PLANS.

FINISHES LEGEND (VERTICAL SURFACES)

- PAINT 'P-1' ACCENT COLOR
- PAINT 'P-2' ACCENT COLOR
- PAINT 'P-3' ACCENT COLOR
- PAINT 'P-4' ACCENT COLOR
- PAINT 'P-5' ACCENT COLOR
- PAINT 'P-6' DRY FALL BLACK
- PAINT 'P-7' ACCENT COLOR
- PAINT 'P-8' ACCENT COLOR
- PAINT 'P-9' ACCENT COLOR

SYMBOLS LEGEND

VERTICAL FINISH ACCENTS - SEE FINISH SCHEDULE FOR ENTIRE ROOM.

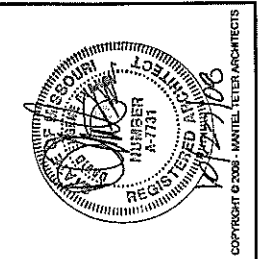
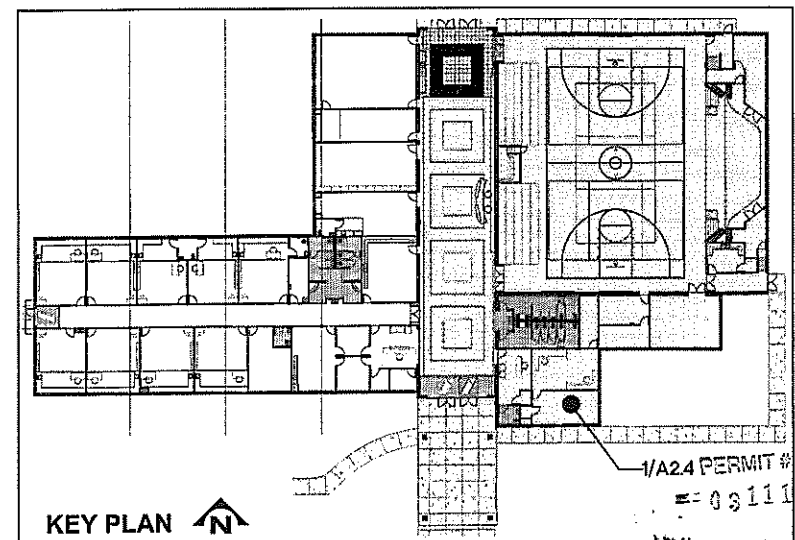

Project Description:
Timothy Lutheran Church
HWY 7 & Wyatt Road
Blue Springs, Missouri 64014

MANTTEL TETER ARCHITECTS
925 WALNUT STREET, SUITE 700 | KANSAS CITY, MISSOURI 64108
TOLL-FREE: 877.215.5600 | P: 816.931.5600 | F: 816.531.7537
WWW.MANTTELARCHITECTS.COM

PROJECT #: 08-543
ISSUE DATE: 10/20/2008
DRAWN BY: ARS
CHECKED BY: SKP

REVISIONS:
1. _____
2. _____
3. _____
4. _____
5. _____

SHEET No. **A2.4**
FINISH PLAN